



Model WG shown with standard Extended SuperSeal Pressure / Temperature ports

Product Information

Body:	Ductile Iron (2 1/2" - 14" models)
Flow Cartridge:	Stainless Steel Wear Surfaces with Stainless Steel Spring
Flanges:	Class 150 ANSI
Rating:	225 PSIG at 250° F

A grooved wafer-style AutoFlow assembly factory set to automatically limit the specified flow to within 5 percent accuracy. Extended SuperSeal Pressure / Temperature ports and a 1/2" FPT with a drain plug on the bottom. The assembly has two grooved adapter flanges that require two standard grooved couplings (not supplied) for field installation. The flanges and flange bolts are shipped assembled.

WG shown with standard SuperSeal P/T ports

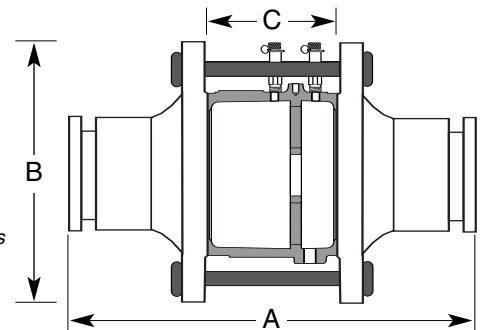

Dimensions not to be used for construction unless prints certified by factory.

Nominal Dimensions & Weights

Model	Size	A	B	C	Weight	Max No. of Cartridges	Maximum GPM (see note 3)				
							2-32 (14-221)	5-60 (34-414)	Control Range		
									3-20	5-40	7-45
WG0250(-)	2 1/2"	19.5	7.00	6.00	24	1	80 (5.0)	120 (7.6)	80 ¹	120 ¹	-
WG0300(-)	3"	22.3	7.50	8.78	35	1	135 (8.5)	170 (10.7)	200	250	300
WG0400(-)	4"	22.8	9.00	8.78	72	2	270 (17.0)	340 (21.5)	400	500	600
WG0500(-)	5"	32.8	10.0	8.78	58	3	405 (25.6)	510 (32.2)	400	500	600
WG0600(-)	6"	23.8	11.0	8.78	69	4	540 (34.1)	680 (42.9)	800	1000	1200
WG0800(-)	8"	18.0	13.5	8.78	105	7	945 (59.6)	1190 (75.9)	1400	1750	2100
WG1000(-)	10"	18.0	16.0	8.78	143	11	1485 (93.7)	1870 (118.0)	2200	2750	3300
WG1200(-)	12"	18.2	19.0	8.78	194	15	2025 (127.8)	2550 (160.9)	3000	3750	4500
WG1400(-)	14"	18.2	21.0	8.78	269	19	2565 (161.9)	3230 (203.0)	3800	4750	5700

Notes:

- The (-) in the model number must be replaced by: **3** (3-20), **4** (5-40) or **5** (7-45); for the WG0250 use **1** (2-32) and **2** (5-60) ranges instead of (3-20) & (5-40).
- For pump head calculations, the following loss applies for each range: **4.6 ft.** (2-32); **11.6 ft.** (5-60); **6.9 ft.** (3-20); **11.6 ft.** (5-40); & **16.2 ft.** (7-45).
- The flows can be reduced in 10 GPM increments; 5 GPM for 2 1/2".
- All weights and dimensions given are in pounds and inches and are subject to minor

Model Order Designation

Model / Size
6" WG Shown

Options w/ Locations

Use for options that require specified locations.
Dual Extended P/T's in Ports 1 & 2 and Ball Drain in Port 3 Shown

GPM
520 GPM Shown

WG0600(-) - DX1&2, UB3 - MI - 520

Options

Use for options that have specific locations.
Metal ID Tag Shown

(-) - insert 1 (2-32), 2 (5-60), 3 (3-20), 4 (5-40), or 5 (7-45)

Options Available

AA Automatic Air Vent

AV Manual Air Vent

HN Hose-end Drain Valve

PI Plastic Tag

SE Stem Extender

XL Ext. P/T Port